

REZIDE



Grove Lane, Barrow Upon Soar, Loughborough

£260,000

Bed - 2 Bath - 1 Rec - 2

A beautifully presented terraced home, offered to the market with no upward chain, nestled within the ever-popular village of Barrow upon Soar. Combining stylish interiors with generous living space and a superb rear garden, this is an ideal opportunity for first-time buyers or those seeking a turnkey home.

- No Upward Chain
- Immaculately Presented Throughout
- Two Double Bedrooms
- Two Reception Rooms
- Modern Fitted Kitchen
- Utility Room & Ground Floor WC
- Popular Village Location
- Generous Rear Garden
- Excellent Local Amenities & Transport Links
- Feature Log Burner

Tenure - Freehold

Council Tax Band -

Energy Efficiency Rating		Current	Potential
Very Good	A		
Good	B		
Decent	C		
Below Average	D		
Poor	E		
Very Poor	F		
Needs Improvement	G		

England & Wales



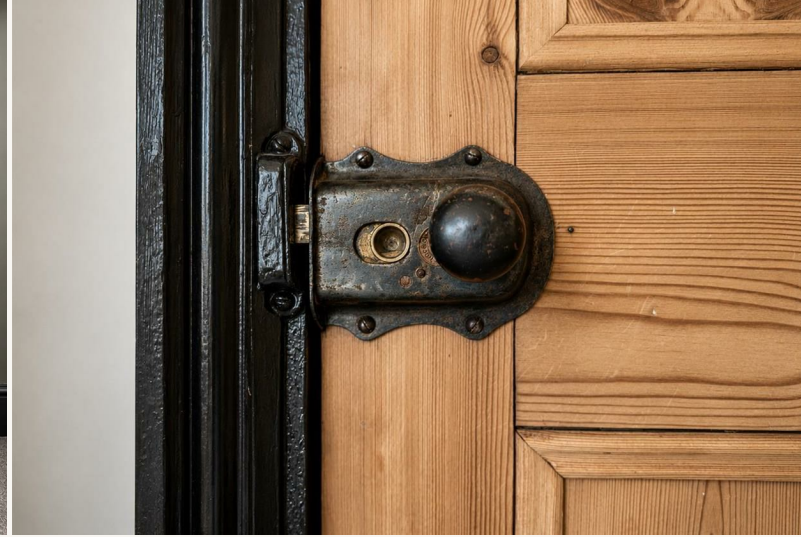

Ground Floor

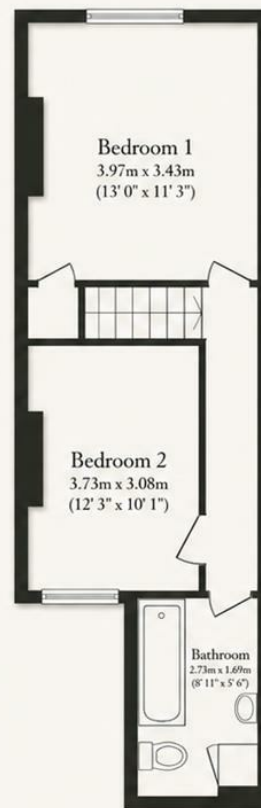

First Floor

Total floor area 85.8 sq.m. (924 sq.ft.) approx

REZIDE

01509 274474



info@rezide.group